

## forklift **BAB** rear mount

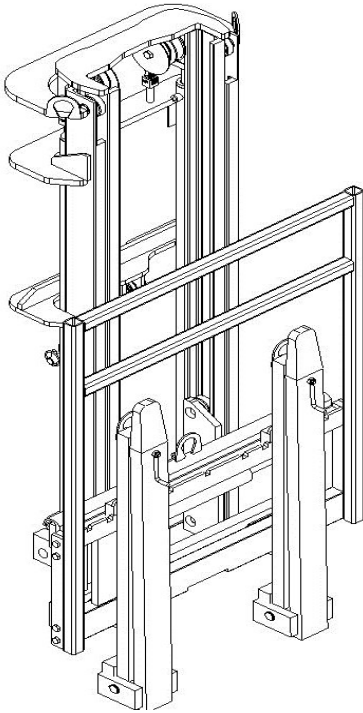

### standard features

- \* capacity 1500 kg
- \* lift height 260 cm
- \* side-shift 20 cm - schuift volledig op brons
- \* width adjustable solid forks - fodable
- \* forks length 100 cm
- \* built of high graded steel
- \* **all bearings equipped with grease nipple**
- \* double acting cilinders

price

### opties

- \* control valve block 3 functions \_\_\_\_\_
- \* elektric control with joystick placed on lever in tractor \_\_\_\_\_
- \* elektric control with joystick and 1 push-pull cable \_\_\_\_\_
- \* proportional elec control Danfoss PVG32 \_\_\_\_\_
- \* nitrogen accumulator \_\_\_\_\_
- \* lift height 320 cm \_\_\_\_\_
- \* fork length 110 cm \_\_\_\_\_
- \* fork length 120 cm \_\_\_\_\_
- \* clamp 2- 3 bins \_\_\_\_\_
- \* base for fixed constrution on tractor \_\_\_\_\_ tractor dependent

This forklift is not addepted for mounting in the tractor's 3-point linkage but should be built fix on the tractors back-side  
For some tractors there are base units available.

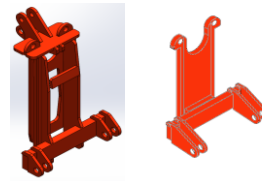

base for Fendt - New Holland