

HERCULES C

The HERCULES is a platform designed and built by BAB.
The first design was done in 2005 and redesigned in 2016 (called HERCULES C) with modern up to date technologies, this to full fill the new needs and norms.
It will give you maximum performance in harvesting, pruning and any other type of work to do in the orchards,



parameter **basic features**

<i>name:</i>	Hercules C made by BAB
<i>engine:</i>	kubota V 1505 4 cyl 2.300 rpm 26 hp water cooled
<i>fuel:</i>	diesel 75 liter fuel tank with level indicator primary filter with water separator, electrical feeding pump and final filter
<i>traction:</i>	permanent 4 x 4 mechanical - hydraulic
<i>control:</i>	joystick with electrical control, integrated death man switch
<i>hydraulic sys:</i>	driving hyd: Danfoss piston pump MP1 32 max oil flow 90 L/min max 300 bar Danfoss piston motor H1 with 2 - speed working hyd: hydac (germany) manifold for hydraulic controls gearpump: 8 cc or 11 cc max 180 bar
<i>driveline:</i>	heavy duty front and rear axle with planetary reduction on differential output front and rear axles connected with high speed PTO shaft front axle with limited slip integrated in differential 2 - speed hydrostatic
<i>speed:</i>	low gear 0 - 6 km/h high gear 0 - 11 km/h only 2 wheel steering with auto alingement of back wheels electrical gear shifting without passing neutral
<i>steering :</i>	3 modes of steering: * 2 wheel steering with automatic alingement of back wheels * 4 wheel steering * 4 wheel steering crab auto alingement system integrated in axles while 4 WS steering angle 38°
<i>parking brake</i>	automatic negative brake with wet disc inboard of rear axle
<i>wheels:</i>	10,0/75 x 15,3 8 ply traction
<i>empty weight</i>	3000 kg - 3500 kg (depending on options)
<i>load capacity :</i>	2300 kg
<i>dimensions:</i>	platform: lenght 4,2 meter in height adjustable till 255 cm with double scissors width hydraulic adjustable from 1,6 (closed) to 2,6 meter (open) machine: zie page added

15-mei-21

opt. 100 max height 285 cm instead of 255 cm

length platform 465 cm (movable part)

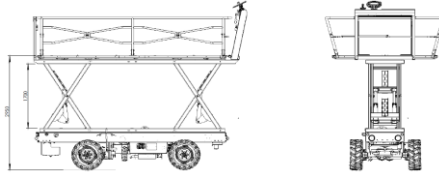

opt. 101 rollers for bins width ajustable for different sizes of bins
can be easily built off after harvest

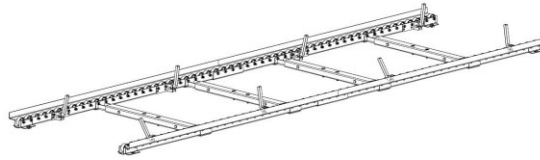

opt. 110 wheels: 31x15,5-15 8 ply BKT tracmaster



opt. 111 wheels: 280/70-R16 BKT RT765 traction
mounted on rim W8 x 16 with adjustable track

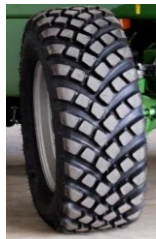

opt. 131 air-compressor 650 liter with air-tank 50 liter , electrical engaged
control unit for pressure setting and water separator
4 removable air connections in the middle of the platform

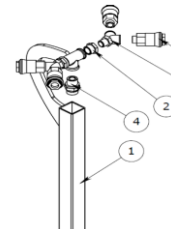

opt. 135 additional air-tank 50 liter



15-mei-21

15/07/2021

opt. 140 table with 4x airconnection for pruning with pressure gauge
tool box



opt. 150 front elevator (max load 600 kg)
adapted for bins



opt. 160 rear elevator (max load 600 kg)
double rollers , outside row in width adjustable
control in the back off platform



opt. 170 platform width from 180 (closed) to 340 cm (open)



opt. 180 automatic steering with mechanical sensing arm
sensing arm in width adjustable with hydraulic cylinder



opt. 182 feeler : sensing arm for detecting the cross cables of the tree cover system
the platform will stop when feeler is touched and can easy resumed by the operator
to protect the steering wheel , workers and also the cover system
mounted on control bridge in front of the steering wheel



opt. 188 automatic steering with sensor Line assist Optical sensor GO-TRACK



opt. 201 cruise control additional to auto steer
set speed will be remembered after changing of line
fine tuning of speed with additional turning knob
start - stop function: machine can be stopped and restarted
digital read out of set speed in km/h



15-mei-21